

A-valve 101 is an angle seat ON/OFF valve made of SST, pneumatic operated

Technical Specification

- Operating pressure: 0–10bar (0–145psi)
- Control pressure: 3–8bar (43.5–116psi)
- Control fluid: Filtered compressed air or neutral gas
- Cylinder material: CF8
- Body material: CF8/CF8M/CF3M and other special materials
- Seal material: PTFE
- Applicable medium: Water, Oil, Air, Liquid, Organic solvent, Acid and lye
- Medium temperature: -10°C — $+180^{\circ}\text{C}$
- Ambient temperature: -10°C — $+80^{\circ}\text{C}$
- Control type: Single acting normally closed, Double acting normally closed, Double acting without spring
- Connection type: Threaded, Welded, Tri-clamp, Flanged
- Leakage class: DIN EN 12266 Class A

Advantages

1. Lightweight appearance, compact structure, and excellent performance.
2. Y-shaped structure design of the valve body features high flow rate, low flow resistance, and rapid action response.
3. Stainless steel actuator, better performance for harsh environments

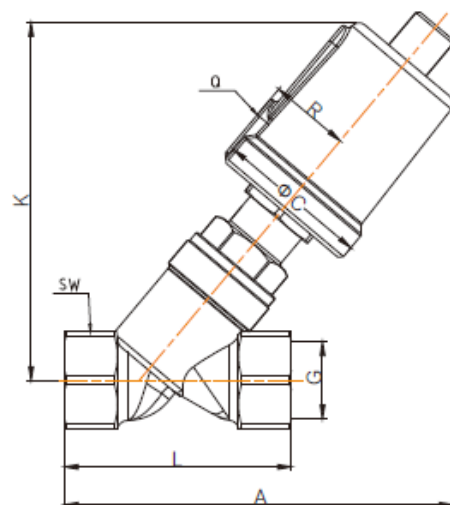

Threaded connection

Dimensions

Size	Actuator (mm)	Q	ϕC	R	K	Threaded connection			
						G	A	L	SW
DN8	28	1/8"	42	21	105	1/4"	115	68	27
DN10	28	1/8"	42	21	105	3/8"	115	68	27
DN15	28	1/8"	42	21	105	1/2"	115	68	27
DN20	40	1/8"	50.5	27	130	3/4"	135	75	32
DN25	40	1/8"	50.5	27	135	1"	145	90	40
DN32	50	1/8"	60	33	165	1 1/4"	180	116	50
DN40	50	1/8"	60	33	170	1 1/2"	180	116	56
DN50	50	1/8"	60	33	175	2"	195	138	69